



SPTE15X/PTE15X

NEW!

EASY MOVER

Semi Electric (Manual Lift) 1.5T/Electric Pallet Truck 1.5T

INTRODUCTION

The SPTE15X/PTE15X is an innovative power pallet truck with a 48V system designed for light duty applications with 1500kg/3300lbs capacity based on our 25 years of experience in pallet truck manufacturing. With its revolutionary system with reduced cost it is the best-value power pallet truck to replace the hand pallet truck as well as the labor involved. Smart design with the easy lift-up and replaceable battery pack allows double the application time.

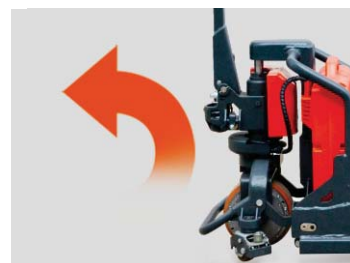

Great Braking Performance

Standard brake for SPTE15X/PTE15X ensures excellent brake performance for most of the applications.



Electric Parking Brake(optional)

The optional Electric Parking Brake (EPB) is an automotive disc brake. This will give the operator high efficiency, fast reaction time, and a safe operation.



SPTE15X



PTE15X

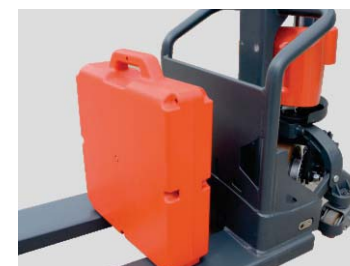

Skeleton Design

The SPTE15X/PTE15X chassis adopts a skeleton structure reducing the total weight of the vehicle, while ensuring structural strength and integrity. The vehicle weight of 165kg/364lbs is 25% lighter than full time use 1500kg electric pallet truck. This reduced weight provides increased flexibility and improved operations.



The Easiest Battery Exchange

The smart design allows easy exchange of the 48 volt battery pack within seconds. When the battery is discharged, lift out and replace with (optional) additional 48 volt battery pack.



48V 20Ah

3.5 Hours Working Time.



Great Speed & Efficiency

Powerful 500w AC drive motor with excellent speed and efficiency. And ensures lowest maintenance cost and smooth acceleration.

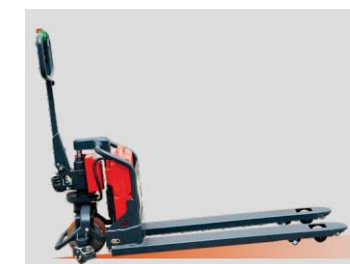

Open Structure

The open structure facilitates the maintenance and maintenance of users.

Excellent Climbing Performance

When fully loaded, the SPTE15X's climbing performance can reach 3.5%.

Multiple Use Methods

A

SPTE15X is a Multiple Use Methods Semi Electric (Manual Lift) Pallet truck.

B

It can be used as a hand pallet truck any time when the power cut off, meanwhile, you can remove the battery to reduce the service weight.

C

Even when the electric components such as motor, controller or battery is out of service after years of use, the SPTE15X's mechanical part can continue to be used as a hand pallet truck with its unique design.



Original

Just Three Steps



Noblelift Ergonomic and Smart Handle



Integrated with operation buttons, battery indicator as well as key switch.

- Operations: Lift/Lower/Horn/Belly button
- Battery Indicator: Digital
- Dual butterfly-style thumb controls for traveling
- Dual lift button for both right-handed or left-handed operators

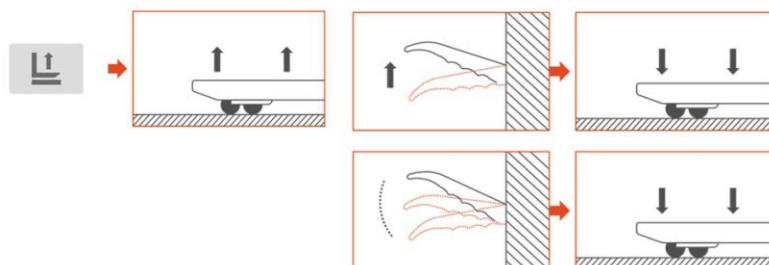

PTE15X , fork lifting is controlled by Lifting Button.
SPTE15X , fork lifting is manually operated.

- Its compact size and light service weight is suitable for narrow areas such as retail stores or mezzanine warehouse.
- Smart design and low service weight allows it to be used in elevators.
- Its high maneuverability and light service weight is ideal to be used in trailers and containers.



Type sheet for industrial truck acc. to VDI 2198 1KG=2.2LB 1INCH=25.4MM

Distinguishing mark	1.2 Manufacturer's type designation		SPTE15X		PTE15X	
	1.3 Drive		Semi Electric		Electric	
	1.4 Operator type		Pedestrian			
	1.5 Load Capacity / rated load		Q (t)	Q(lbs)	1.5	3300
Weight	1.6 Load centre distance		c (mm)	X(in)	600	23.6
	1.8 Load distance ,centre of drive axle to fork		x (mm)	Y(in)	947	40
	1.9 Wheelbase		y (mm)	Z(in)	1270	52.7
	2.1 Service weight		kg	(lbs)	165	363
Tyres, chassis	2.2 Axle loading, laden front/rear		kg	(lbs)	610/1055	1345/2318
	2.3 Axle loading, unladen front/rear		kg	(lbs)	128/37	282/81
	3.1 Tires		Polyurethane(PU)			
	3.2 Tire size,front		Ø x w (mm)	ØX W(in)	Ø230X61	Ø9X2.4
Dimensions	3.3 Tire size,rear		Ø x w (mm)	ØX W(in)	Ø80X70	Ø3.15X3.66
	3.4 Additional wheels(dimensions)		Ø x w (mm)	ØX W(in)	Ø80X30	Ø3.15X1.18
	3.5 Wheels,number front/rear(x=driven wheels)				1X+2/4	1X+2/2
	3.6 Tread, front		b10 (mm)	b10(in)	420	16.5
Performance data	3.7 Tread, rear		b11 (mm)	b11(in)	380	20.7
	4.4 Lift		h3 (mm)		115	4.5
	4.9 Height of tiller in drive position min./ max.		h14 (mm)	h3(in)	840/1260	33/49.6
	4.15 Height, lowered		h13 (mm)	h14(in)	85	3.15
Electric- Motor	4.19 Overall length		l1 (mm)	h13(in)	1650	67.6
	4.20 Length to face of forks		l2 (mm)	l1(in)	501	19.6
	4.21 Overall width		b1 (mm)	l2(in)	540	27
	4.22 Fork dimensions		s/e/l (mm)	b1(in)	48/160/1150	1.9/6.3/48
Additional data	4.25 Distance between fork- arms		b5 (mm)	s/e/l(in)	540	27
	4.32 Ground clearance, centre of wheelbase		m2 (mm)	b5(in)	37	1.46
	4.34 Aisle width for pallets 800X1200 lengthways		Ast (mm)	Ast(in)	2120	84.9
	4.35 Turning radius		Wa (mm)	Wa(in)	1450	59.8
Performance data	5.1 Travel speed, laden/ unladen		km/h		4.8/5.0	3.0/3.1
	5.2 Lift speed, laden/ unladen		m/s	mph	—	—
	5.3 Lowering speed, laden/ unladen		m/s	fpm	0.088/0.088	17.3/17.3
	5.8 Max. gradeability, laden/ unladen		%	fpm		3.5/20
Electric- Motor	5.10 Service brake			%	Motor Braking+EPB(Optional)	
	6.1 Drive motor rating S2 60min		kW		0.5	0.67
	6.2 Lift motor rating at S3 10%		kW		—	—
	6.3 Battery acc. to DIN 43531/ 35/ 36 A, B, C, no			HP		0.8
Additional data	6.4 Battery voltage, nominal capacity K5		V/ Ah	HP	No	
	6.5 Battery weight		kg	V/Ah	48V/20	
	6.6 Energy consumption acc. to VDI cycle		kWh/h	(lbs)	0.2	
	8.1 Type of drive control				AC speed Control	
Additional data	8.4 Sound level at driver's ear acc. to EN 12053		dB(A)		< 60	

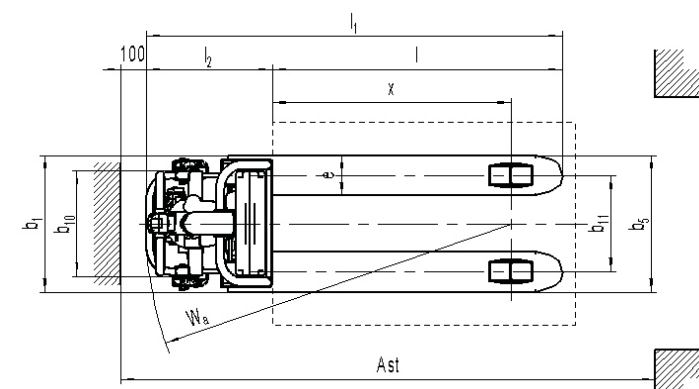
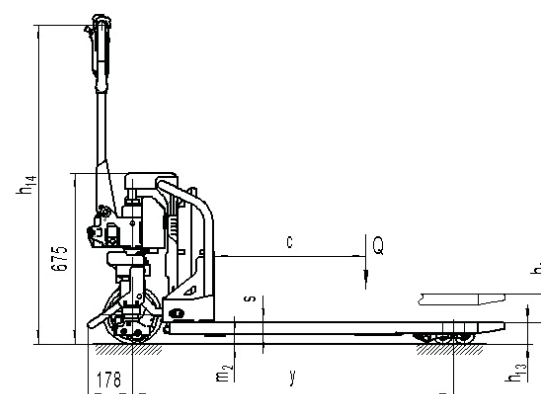



PT E12

Economic Pedestrian Power Pallet Truck with capacity of 1200kg

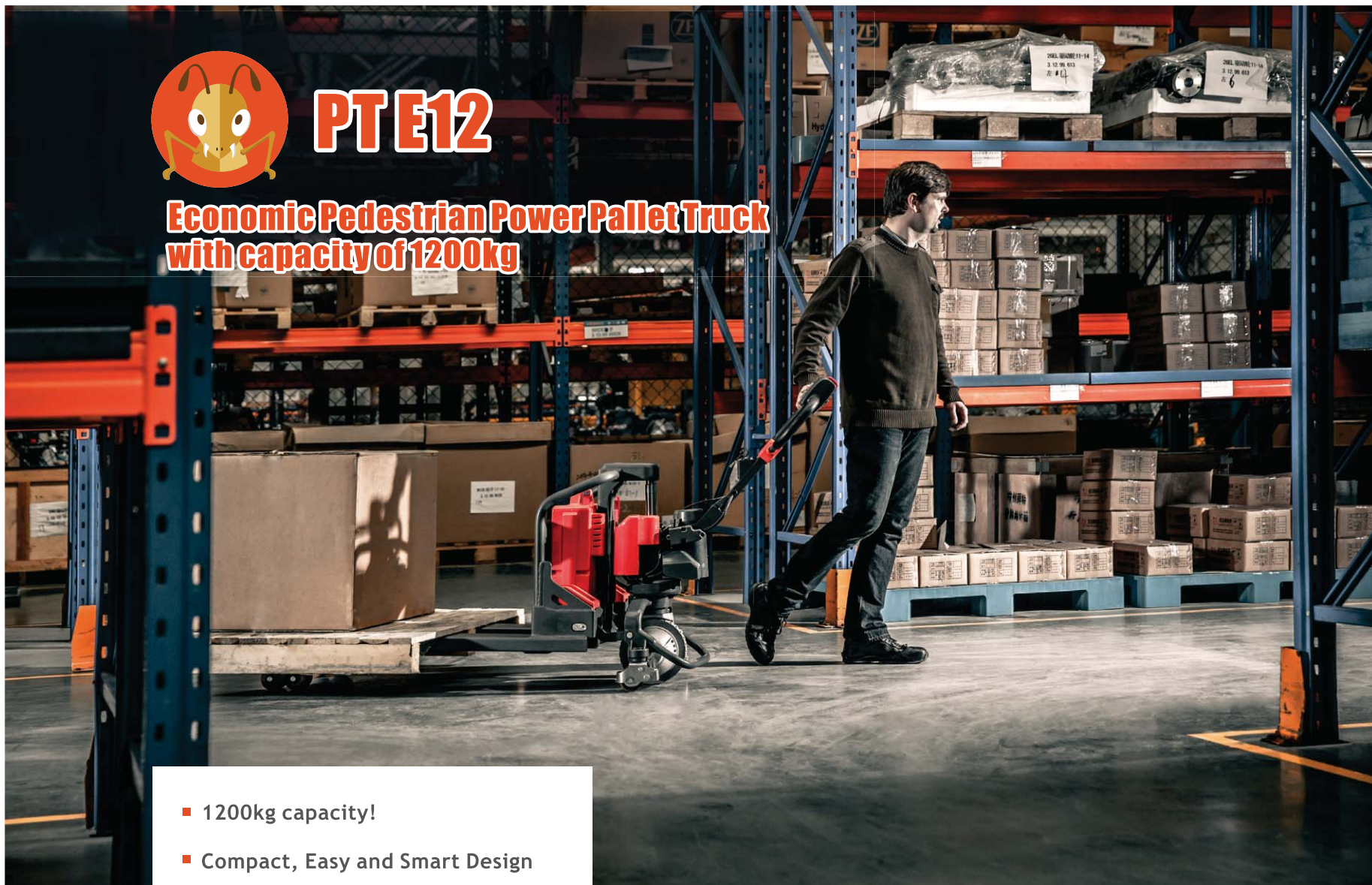

- 1200kg capacity!
- Compact, Easy and Smart Design
- Designed for Downtown Deliveries on the last meters
- Low Service Weight predestinated for Tail-lift use
- Low Noise High Quality Drive Motor

INTRODUCTION

The PT E12 is designed for the last “Mile”-deliveries where the pallet weight is not more than 800kg normally. With its low service weight the truck is tailored to the downtown low duty delivery applications with tail- lifts.

▶ Ergonomic tiller with Battery Discharge Indicator

We concentrated on ergonomic and easy solutions. The result is a smart control and indication unit, where all necessary functions are implemented.

▶ Electric lifting function with long tiller

The electric lifting function gives the operator the daily comfort which is required for daily operations. Through the electric lifting button the load is effortless lifted while the manually lowering lever gives more sensitivity to be able to place the goods silently.

▶ Exchangeable battery

The PT E12 is equipped with an powerful 45 Ah maintenance free AGM battery system. When the battery capacity comes to an end, the truck can be further operated by just replacing the battery with another one (option) to enlarge (double) the operating time.



▶ Less Service costs with less wiring

The components are arranged in a way which reduces the wiring and which reduces possible electrical defects. The controller is assembled directly to the electrical lifting system. The only lifted cables are the battery cables.

Optional Non-marking rubber drive wheel gives better traction ideal for outdoor or delivery applications.



▶ Low Service weight and robust design

Through the total new design, the truck is robust at the drive end side as well as to the fork-side. All parts are easy to maintain.

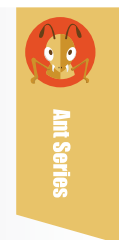



PT E15

Economic Power- Electric Pallet Truck Compact and Reliable Design

INTRODUCTION

The PT E15 is an economic walkie-electric pallet truck, with rated capacity of 1500kg/3300lbs.

The compact and light design is suitable for a variety low duty applications in ware-houses or delivery applications on lorries with tail lifts.

With the electric lifting and the lowering both function can be controlled easy and safe.

ADVANTAGES

- Ideal solution for low-duty applications.
- Built- in charger for high autonomy optional external charger available.
- Battery discharge indicator with automatic lift cut-off function for higher battery lifetime.
- Additional stabilization through stabilizers.
- Optional backrest on request.
- Several fork versions and backrest available on request

Unique design with the electric lifting and the lowering lever, both function can be controlled easy and safe.



Built-in charger

The built-in charger makes operations more autonomy and increases the operating range. Optional external charger .



Easy pallet entry

Additional entry rollers ensure easy pallet entry and preventing possible damages.



Robust chassis

Robust chassis with reinforced fork-structure (7mm together).

Sideways castors

Sideways castors ensure travelling stability and safety in medium applications.



The powerful 64Ah (2x12V 64Ah) batteries gives enough autonomy the truck needs. Optional 2x12V 85Ah battery.



Deep discharge protection

Proofed and ergonomic emergency button and discharge indicator, more robust and reliable than other. The included automatic battery protection ensures high lifetime for the batteries.

Proofed components

Proofed components such as sensors micro-switches and controller, and hydraulic units from international brands.

Fulfilling standards

Fulfilling the actual valid European standards, also in ISO 13849, performance level.



Suspension Castors

Suspension castors better with performance in overcoming obstacles, high travelling stability, and less wear & noise.

Protection

Motor and wheel protection out of robust metal. Also gives perfect foot protection.





EPT 15 / SPT 15

Economic Power- Electric Pallet Truck Compact and Reliable Design

INTRODUCTION

The EPT 15 / SPT 15 is an economic walkie-electric / semi-electric pallet truck, with rated capacity of 1500kg/3300lbs.

The compact and light design is suitable for a variety low duty applications in ware-houses or delivery applications on lorries with tail lifts.

ADVANTAGES

- Ideal solution for low-duty applications.
- Built- in charger for high autonomy.
- Battery discharge indicator with automatic lift cut-off function for higher battery lifetime.
- Additional stabilization through stabilizers.
- Optional backrest on request.



EPT 15

EPT 15W / EPT 15C



SPT 15



Built-in charger

The built-in charger makes operations more autonomy and increases the operating range.



Easy pallet entry

Additional entry rollers ensure easy pallet entry and preventing possible damages.



Robust chassis

Robust chassis with reinforced fork-structure (7mm together).



Protection

Motor and wheel protection out of robust metal. Also gives perfect foot protection.

Sideways castors

Sideways castors ensure travelling stability and safety in medium applications.



Powerful batteries

EPT 15: 2x12V 64Ah (option 85Ah)
SPT 15: 2X12V 40Ah (option 64Ah)
powerful VRLA-AGM maintenance-free batteries.



Deep discharge protection

Proofed and ergonomic emergency button and discharge indicator, more robust and reliable than other. The included automatic battery protection ensures high lifetime for the batteries.

Proofed components

Proofed components such as sensors micro-switches and controller, and hydraulic units from international brands.

Fulfilling standards

Fulfilling the actual valid European standards, also in ISO 13849, performance level.



Suspension Castors

EPT 15W and EPT 15C with suspension castors better with performance in overcoming obstacles, high travelling stability, and less wear & noise.



Ant Series



EPT 15C: 1500kg capacity with rubber drive wheel, who else can offer this for delivery application?

- With the larger drive wheel diameter of 230mm travelling over obstacles becomes effortless.
- The soft but reliable rubber material gives the traction where it is needed.
- Because the truck is used inside as well as partly outside, our material is designed as standard in "Non Marking".
- Shocks are absorbed by the rubber wheel.
- High quality and high efficient European motor.
- Additional large diameter sideways castors emphasize even more the perfect travelling behaviour.



- Through the LOW NOISE the truck is predestinated for delivery applications in residential areas as well as in city center during closing hours or within the night.

Type sheet for industrial truck acc. to VDI 2198 1KG=2.2LB 1INCH=25.4MM

Distinguishing mark	1.2	Manufacturer's type designation		EPT 15		SPT 15	
	1.3	Drive		Electric		Battery	
	1.4	Operator type		Pedestrian		Pedestrian	
	1.5	Load Capacity / rated load	Q (t)	1.5		1.5	
	1.6	Load centre distance	c (mm)	600		600	
	1.8	Load distance ,centre of drive axle to fork	x (mm)	946		946	
	1.9	Wheelbase	y (mm)	1293		1279	
Weight	2.1	Service weight	kg	190	200	165	175
	2.2	Axle loading, laden front/rear	kg	510/1180	560/1140	458/1207	480/1195
	2.3	Axle loading, unladen front/rear	kg	150/40	160/40	130/35	140/35
Tyres, chassis	3.1	Tires		Polyurethane (PU)		Polyurethane (PU)	
	3.2	Tire size,front	Ø x w (mm)	Ø 220×70(230×73) ³⁾		Ø 220×70	
	3.3	Tire size,rear	Ø x w (mm)	Ø 80×70	Ø 80×93	Ø 80×70	Ø 80×93
	3.4	Additional wheels(dimensions)	Ø x w (mm)	Ø 50(80) ¹⁾ ×30		Ø 50×30	
	3.5	Wheels,number front/rear(x=driven wheels)		1x +2/ 4	1x +2/ 2	1x +2/ 4	1x +2/ 2
	3.6	Tread, front	b10 (mm)	340(410) ¹⁾		340	
	3.7	Tread, rear	b11 (mm)	380		380	
Dimensions	4.4	Lift	h3 (mm)	115		115	
	4.9	Height of tiller in drive position min./ max.	h14 (mm)	800 / 1170		850 / 1295	
	4.15	Height, lowered	h13 (mm)	85(80)	80	85(80)	80
	4.19	Overall length	l1 (mm)	1648(1660) ¹⁾	1718(1730) ¹⁾	1666	1736
	4.20	Length to face of forks	l2 (mm)	498(510) ¹⁾		516	
	4.21	Overall width	b1 (mm)	560(574) ¹⁾	705	560	705
	4.22	Fork dimensions	s/e/l (mm)	48/160/1150 ²⁾	48/160/1220 ²⁾	48/160/1150 ²⁾	48/160/1220 ²⁾
	4.25	Distance between fork- arms	b5 (mm)	540(520)	685(520,540)	540(520)	685(520,540)
	4.32	Ground clearance, centre of wheelbase	m2 (mm)	37(32)	32	37(32)	32
	4.34	Aisle width for pallets 800X1200 lengthways	Ast (mm)	1950		1961	
	4.35	Turning radius	Wa (mm)	1445(1460) ¹⁾		1507	
Performance data	5.1	Travel speed, laden/ unladen	km/h	4.2/4.4		4.2/4.4	
	5.2	Lift speed, laden/ unladen	m/s	0.03 / 0.053		-	
	5.3	Lowering speed, laden/ unladen	m/s	0.049 / 0.036		-	
	5.8	Max. gradeability, laden/ unladen	%	4/10		4 / 10	
	5.10	Service brake		Electromagnetic		Electromagnetic	
Electric- Motor	6.1	Drive motor rating S2 60min	kW	0.45		0.45	
	6.2	Lift motor rating at S3 10%	kW	0.8		-	
	6.3	Battery acc. to DIN 43531/ 35/ 36 A, B, C, no		No		No	
	6.4	Battery voltage, nominal capacity K5	V/ Ah	2x12V / 64		2x12 / 40	
	6.5	Battery weight	kg	48		30	
	6.6	Energy consumption acc. to VDI cycle	kWh/h	0.39		-	
Additional data	8.1	Type of drive control		DC-Speed Control		DC-Speed Control	
	8.4	Sound level at driver's ear acc. to EN 12053	dB(A)	69		69	

Note: ¹⁾For EPT 15W with suspension castors ²⁾ With optional length 800mm and 1000mm ³⁾ For EPT 15C with rubber steering wheel

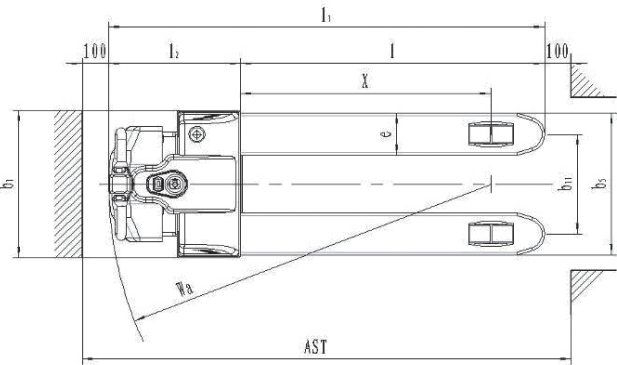
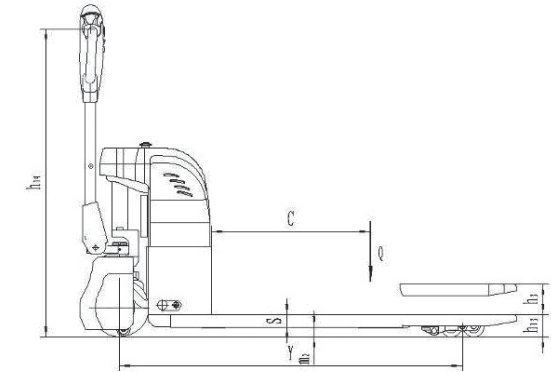



EPT 15SC

Electric Pallet truck with scale



Standard ESR-EL-4 kit for EPT15SC:

- Tolerance: +/-0.4% of the rated truck capacity 1500kg(max +/-6kg) by standard loadcells.
- Graduation in 1 and 2kg steps(multirange)
- Scale functions: zero correction, gross/net weighing, total weight.
- Power supply: 4x1.5V AA batetries.
- Low battery warning + auto shut off function after 3 minutes.

Totalising function

Adds up multiple pallet weights to a total weight per shipment or order, also for avoiding overloads. When weight is added, the display shows the new total weight and the number of pallets weighed. This permits the user to verify that he did not forget to weigh any pallets or weighed the same pallet twice.



High battery autonomy

Four standard AA-batteries (2.7Ah) allow 70 hours of use. The automatic sleep mode assures that 4200 weighting actions can be taken. In most common use this means that batteries will have to be changed* only one time per year (*or charged if rechargeable batteries are used).

High contrast display

Display can be read from any angle: when operator is standing near the pallet for dosing, or for adding products to the pallet by weight. The display does not need a backlight because it reads extremely well at ambient light conditions.

Big function keys that "click "

When pushing the function keys, the operator senses a "click" movement. Even when working with gloves, the operator feels whether he has pressed the key properly.

Water and dust proof to norm IP65

One of the most important characteristics for a reliable mobile scale. IP65 means that the pallet truck scale can be used outside or lorries and be cleaned with water (but not by high pressure!!!) The load cells in the forks have an even higher protection level. Product is CE conform for Europe and FUC conform for the USA.

OPTIONAL

Option 1: Improved Accuracy

- Tolerance: +/-0.2% of the rated truck capacity by better loadcells.
- Graduation in 1kg steps for the full range.

Option 2: Power supply by truck battery

- Internal power converter with input range 12-40V.

Option 3: Thermal Printer

Printer which is reliable in mobile applications. Use of printer does hardly influence the life time of the batteries. The printer is protected for use at low battery voltage levels. The printer is also resistant to vibrations and shocks.

Type sheet for industrial truck acc. to VDI 2198 1KG=2.2LB 1INCH=25.4MM

Distinguishing mark	1.2	Manufacturer's type designation		EPT15SC
	1.3	Drive		Electric
	1.4	Operator type		Pedestrian
	1.5	Load Capacity / rated load	Q(t)	1.5
	1.6	Load centre distance	c(mm)	600
	1.8	Load distance ,centre of drive axle to fork	x(mm)	946
Weight	1.9	Wheelbase	Y(mm)	1293
	2.1	Service weight	kg	235
	2.2	Axle loading, laden front/rear	kg	515/1220
Tires, chassis	2.3	Axle loading, unladen front/rear	kg	170/65
	3.1	Tires		Polyurethane (PU)
	3.2	Tire size, front	Øx w (mm)	Ø200 x 70
	3.3	Tire size, rear	Øx w (mm)	Ø80x70
	3.4	Additional wheels(dimensions)	Øx w (mm)	Ø80x30
	3.5	Wheels, number front/rear(x=driven wheels)		1x+2/4
	3.6	Track, front	b10mm	410
Dimensions	3.7	Track, rear	b11 (mm)	380
	4.4	Lift	h3 (mm)	115
	4.9	Height of tiller in drive position min./ max.	h14mm	800/1170
	4.15	Height, lowered	h13mm	90
	4.19	Overall length	l1mm	1675
	4.20	Length to face of forks	l2mm	510
	4.21	Overall width	b1mm	574
	4.22	Fork dimensions	s/e/l (mm)	56/180/1143
	4.25	Distance between fork-arms	b5 (mm)	560
	4.32	Ground clearance, centre of wheelbase	m2mm	23
	4.34	Aisle width for pallets 800X1200 lengthways	Ast (mm)	1950
Performance data	4.35	Turning radius	Wa (mm)	1470
	5.1	Travel speed, laden/ unladen	km/h	4.2/4.6
	5.2	Lift speed, laden/ unladen	m/s	0.03/0.53
	5.3	Lowering speed, laden/ unladen	m/s	0.049/0.036
	5.8	Max. gradeability, laden/ unladen	%	4/10
	5.10	Service brake		electromagnetic
Electric- engine	6.1	Drive motor rating S2 60min	kW	0.45
	6.2	Lift motor rating at S3 10%	kW	0.8
	6.3	Battery acc. to DIN 43531/35/36 A, B, C, no		no
	6.4	Battery voltage, nominal capacity K5	V/Ah	2x12V / 64
	6.5	Battery weighi	kg	48
	6.6	Energy consumption acc: to VDI cycle	kWh/h	0.39
Additional data	8.1	Type of drive control		DC speed Control
	8.4	Sound level at driver's ear acc. to EN 12053	dB(A)	69

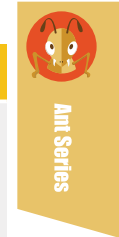
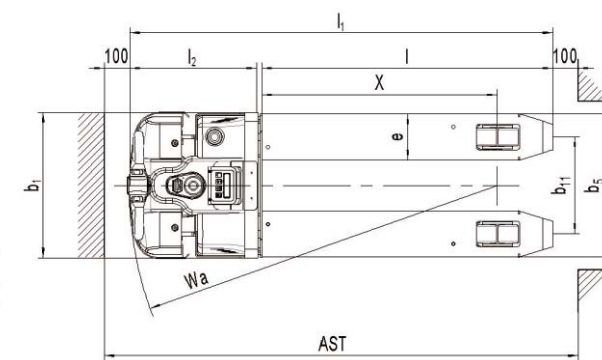
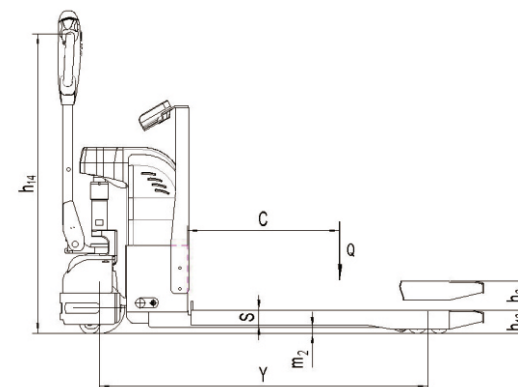



PTE18L



Economic Long-tiller Electric Pallet Truck

INTRODUCTION

The PTE18L Electric Pallet Truck is the ideal choice for material transportation in short-distance or trailer loading/unloading. It is developed based on PT20L targeting to markets such as North American market. It is equipped with AC drive unit, Curtis Controller and maintenance-free battery and built-in charger, competitive in cost with attractive price comparing to counterparts in the industry.

**WITH HIGH PRICE/
PERFORMANCE RATIO**

- Continuous work of 7 hours
- Adapt to any conditions

ADVANTAGE:

- Ergonomic, Compact and Safe Long Tiller Design
- High Performance Maintenance-free AC Drive Unit
- Bigger Ground Clearance for Tough-ground Applications
- Competitive Cost with Excellent Performance



Special design

Special design for fork tip with 3 entry rollers and 4 exit rollers for easy entry and exit of the pallet, esp. when the pallet is empty or light loaded.



Built-in Charger

The built-in charger is located above the battery, easy charging after opening the battery cover.



Creep Button

Creep/Slow speed button for safe and easy operation esp. in confined spaces such as steering in the trailer.



Bigger ground clearance

Bigger ground clearance, for easy operation for uneven grounds with potholes or small obstacles such as small thresholds or on trailers with lifting gates.

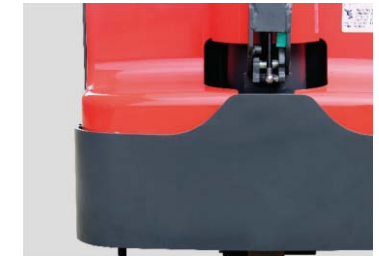

Robust and Reliable Design

The robust chassis with the strong 8mm thick apron protects the truck and the components against mechanical impacts from the outside. The steel battery cover ensures the battery well protected. IP54 protection for the controller for safe operation for delivery applications where the dust and water droplets is common.

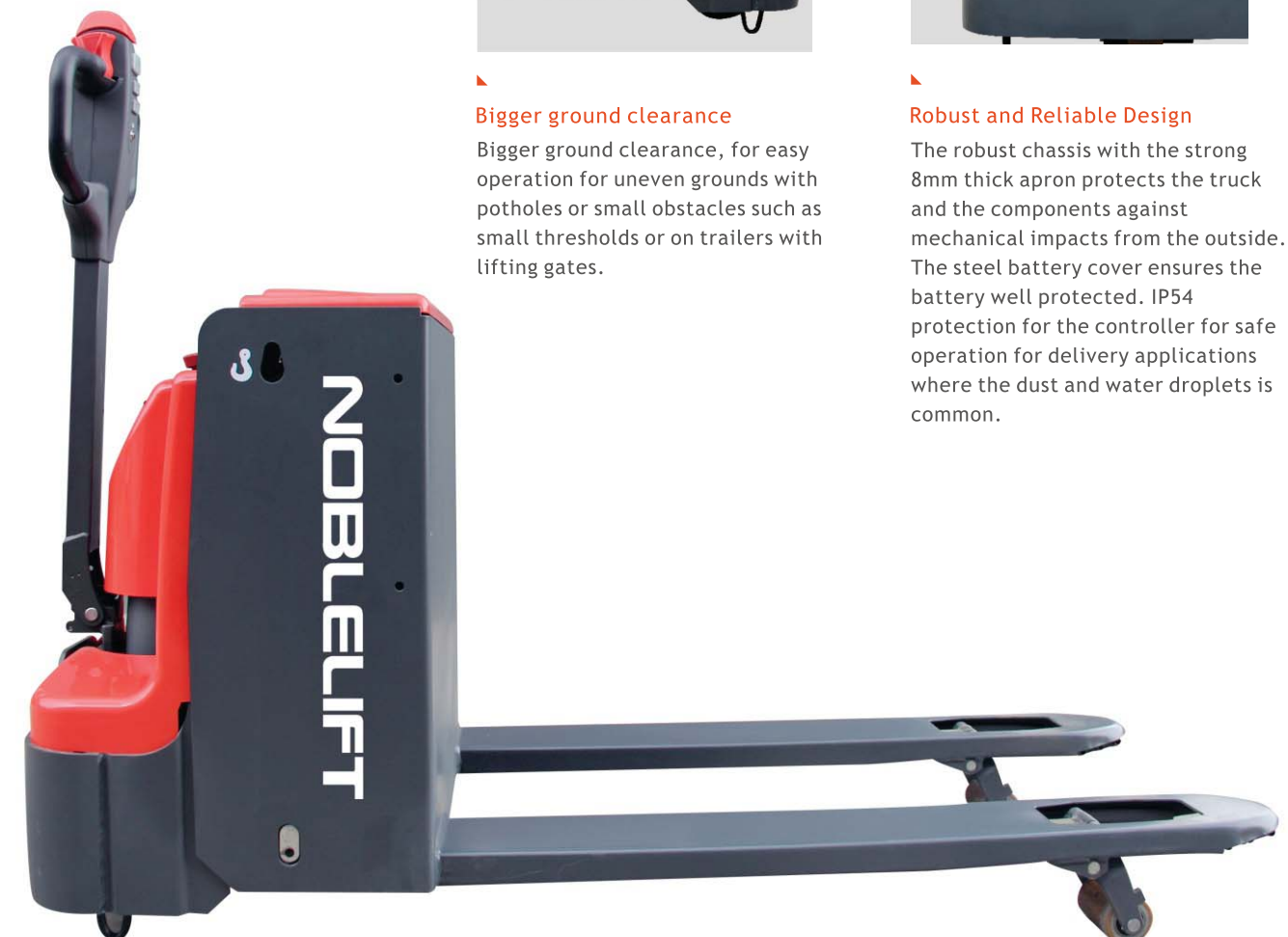



Big capacity Maintenance-free Battery

Equipped with 160Ah maintenance-free battery, with working time 12hours according to the VDI calculation, or for continuous work of 7 hours. There are many advantages comparing to Lead-acid battery:

- No acid refilling maintenance
- Less cable corrosion with the connection pile head
- More protection on over-charging
- Bigger initiating current
- Longer electricity storage time
- More environment-friendly

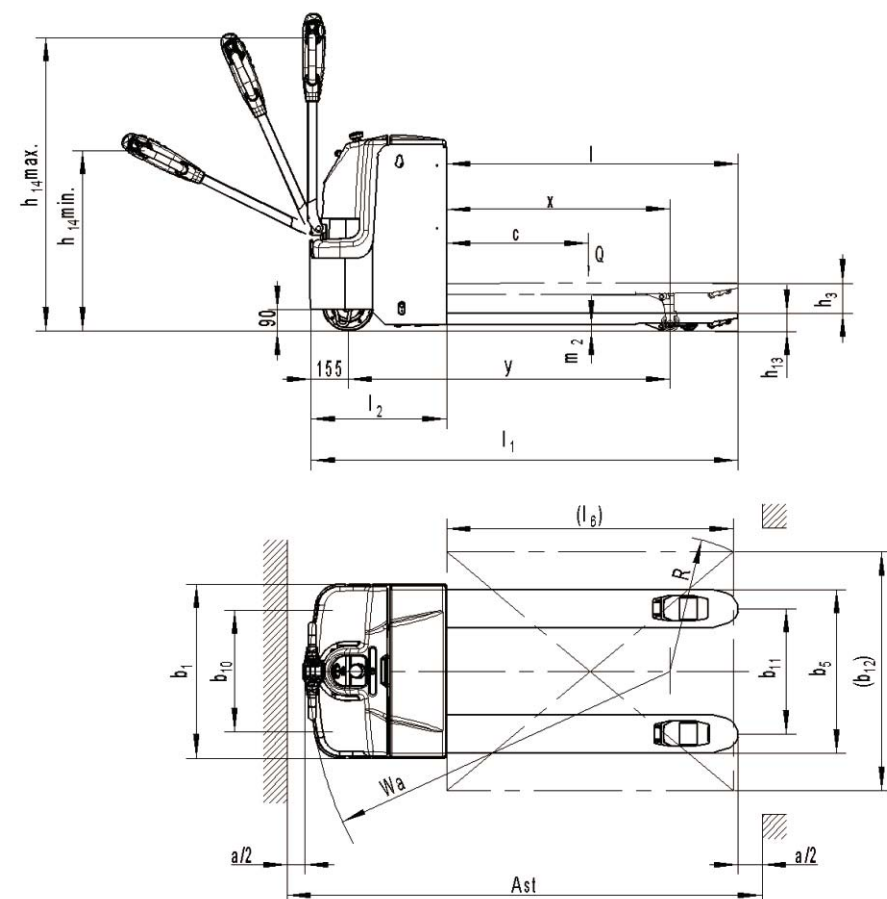

Type sheet for industrial truck acc. to VDI 2198 1KG=2.2LB 1INCH=25.4MM				
Distinguishing mark	1.2	Manufacturer`s type designation		PTE18L
	1.3	Power(battery,diesel,petrol gas>manual)		Battery
	1.4	Operator type		pedestrian
	1.5	Load Capacity / rated load	Q (t)	1.8
	1.6	Load centre distance	C (mm)	600
	1.8	Load distance, centre of drive axle to fork	X (mm)	948 ¹⁾
	1.9	Wheelbase	y (mm)	1360 ¹⁾
Weight	2.1	Service weight	kg	415
	2.2	Axle loading, laden front/rear	kg	785/1430
	2.3	Axle loading, unladen front/ rear	kg	335/80
Tires, chassis	3.1	Tires		Polyurethane (PU)
	3.2	Tire size, front	ø x w (mm)	210X70
	3.3	Tire size, rear	ø x w (mm)	74X100
	3.4	Additional wheels (dimensions)	ø x w (mm)	/
	3.5	Wheels, number front/ rear(x=driven wheels)		1x+2
	3.6	Tread, front	b10 (mm)	510
	3.7	Tread, rear	b11 (mm)	525
Dimensions	4.4	Lift height	h3 (mm)	120
	4.9	Height of tiller in drive position min. / max.	b14 (mm)	770/1230
	4.15	Height, lowered	b13 (mm)	75
	4.19	Overall length	l1 (mm)	1790
	4.20	Length to face of forks	l2 (mm)	570
	4.21	Overall width	b1 (mm)	729
	4.22	Fork dimensions	s/e/l (mm)	50/160/1220(1150)
	4.25	Distance between fork-arms	b5 (mm)	685
	4.32	Ground clearance, centre of wheelbase	m2 (mm)	25
	4.34	Aisle width for pallets 1000X1200 lengthways	Ast (mm)	2270
	4.35	Turning radius	Wa (mm)	1525 ¹⁾
Performance data	5.1	Travel speed, laden/ unladen	km/h	5.0/5.2
	5.2	Lift speed, laden/ unladen	m/s	0.025/0.030
	5.3	Lowering speed, laden / unladen	m/s	0.030/0.025
	5.8	Gradeability, laden/ unladen	%	8/12
	5.10	Service brake		Electromagnetic
Electric- engine	6.1	Drive motor rating S2 60min	kW	0.75
	6.2	Lift motor rating at S3 10%	kW	0.8
	6.3	Battery acc. to DIN 43531 /35 / 36 A, B, C, no		/
	6.4	Battery voltage, nominal capacity K5	V/Ah	24/160
	6.5	Battery weight (minimum)	kg	145
Addition data	8.1	Type of drive control		AC -Speed Control
	8.4	Sound level at driver`s ear acc. to EN 12053	dB(A)	69

1) Load section lowered: +62mm





Economic Electric Pallet Truck

INTRODUCTION

The economic electric pallet Truck PTE20X is the ideal choice for short-distance transportation of goods. The new unique design with 36V system with powerful traction and compact design for confined space operations. The side-battery replacement is easy to exchange the battery for multi-shift operation.



Advantages:

- Long tiller design for easy steering
- Unique 36V system with high performance
- Powerful battery with 6 hours using time
- Bigger supporting wheels for high stability
- Side-battery replacement for easy battery change
- Robust chassis and apron for long service life
- Metal battery cover for better protection
- Compact and smart design for easy maintenance

High Performance Comfortable operation

- Unique 36V system
- High performance side-battery-replacement



⚡ 36V The Unique 36V Systems:

Comparing to 24V systems, the 36V system has obvious advantages: the same power, reduce operating current by 1/3, so the heat losses from the vehicle power is also reduced by 1/3, comprehensive energy consumption is lower; less current in operation significantly reduce the heat of the battery and motor, can effectively reduce the possibility of the battery and motor failure.

Noblelift developed the 36V drive system specifically for PTE20X, the energy consumption (according to the VDI cycle) is only 0.28kWh/h, far less than the products of the same capacity, even lower than the energy consumption of our existing EPT15 1.5 ton truck (0.39kWh/h). So the battery can actually last much longer than the similar trucks.

The speed for PTE20X is 5.8 /5.5Km/h, much faster than the 1500-1800kg capacity truck in market, while its capacity is 2000kg, which delivers high efficiency to you with economic cost.

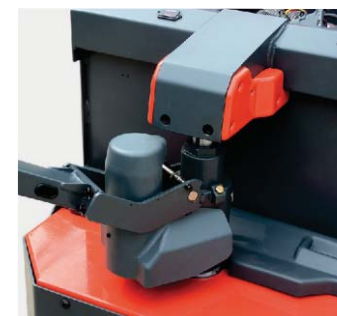

▶ **Integrated hydraulic pump**
One-piece integrated hydraulic pump with compact size.

▶ **Bigger Steering wheel for stability**
The bigger steering wheels ensures high stability for the pallet truck.

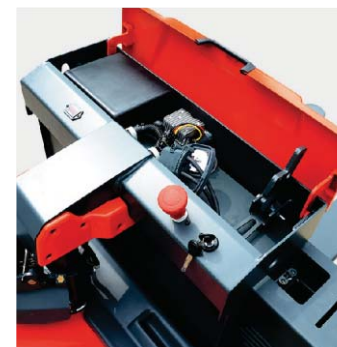

▶ **Unique new 36V system**
36V system with high performance of the battery for longer operation approximately 6 hours.

▶ **Optional Battery Charger**
Standard built-in charger and optional external charger for different customer needs.



▶ **High performance side-battery-replacement**
High performance 36V battery, with side battery replacement easy for battery replacement and maintenance.

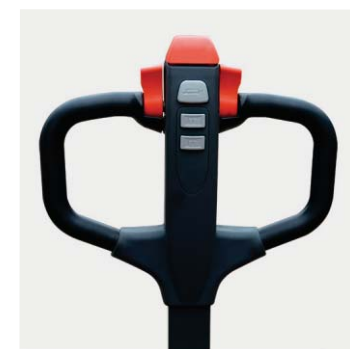

▶ **Long tiller design for ergonomics and safety**
Ergonomic long tiller design for comfortable and efficient operation, keep a safe distance for the operator ensures safety.



▶ **Robust and reliable design**
The robust chassis with the strong thick apron protects the truck and the components against mechanical impact from outside. The metal battery cover protects the battery well from outside too.



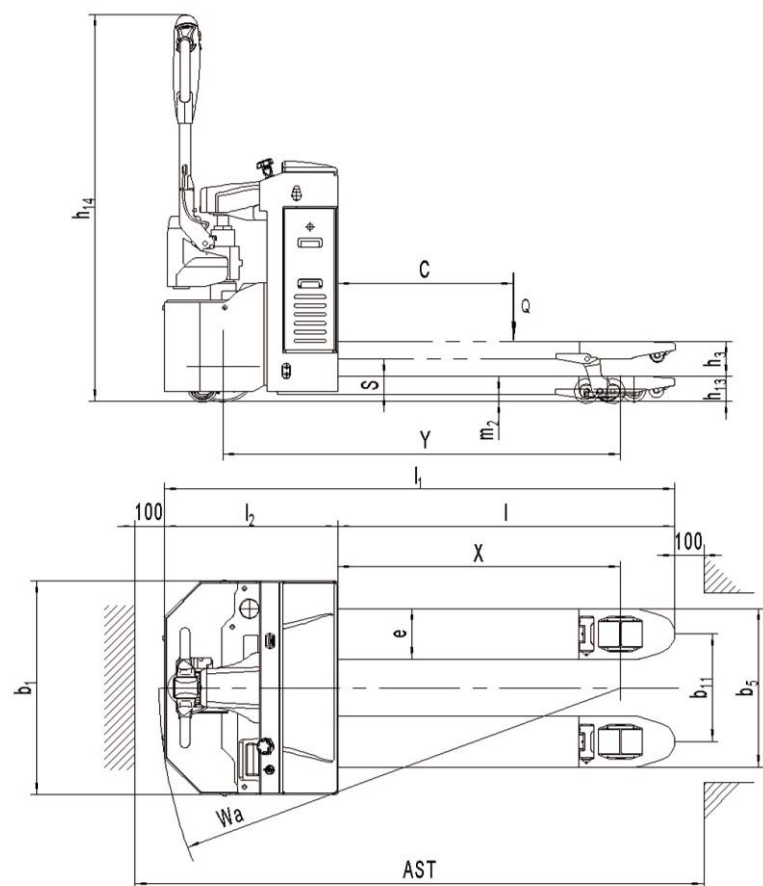

PTE20X

Type sheet for industrial truck acc. to VDI 2198 1KG=2.2LB 1INCH=25.4MM

Distinguishing mark	1.2	Manufacturer's type designation		PTE20X	
	1.3	Power (battery ,diesel, petrol, gas, manual)		Battery	
	1.4	Operator type		Pedestrian	
	1.5	Load Capacity / rated load	Q(t)		2.0
	1.6	Load centre distance	c(mm)	600	600
	1.8	Load distance ,center of drive axle to fork	x(mm)	965	1035
	1.9	Wheelbase	Y(mm)	1362	1432
Weight	2.1	Wheelbase	kg	405	410
	2.2	Axle loading, laden front/rear	kg	785/1620	785/1625
	2.3	Axle loading, unladen front/rear	kg	315/90	315/95
Tires, chassis	3.1			Polyurethane (PU)	
	3.2	Tire size, front	Øx w (mm)	Ø242×80	
	3.3	Tire size, rear	Øx w (mm)	Ø84×85	Ø82×110
	3.4	Additional wheels(dimensions)	Øx w (mm)	Ø100×40	
	3.5	Wheels,number front/ rear(x=driven wheels)		1×+2/2; +2/4	1×+/-2;+2/2
	3.6	Tread, front	b10mm	500	
	3.7	Tread, rear	b11 (mm)	367/512	
Dimensions	4.4		h3 (mm)	115	
	4.9	Height of tiller in drive position min./ max.	h14mm	880/1290	
	4.15	Height, lowered	h13mm	83	
	4.19	Overall length	l1mm	1750	1820
	4.20	Length to face of forks	l2mm	600	
	4.21	Overall width	b1mm	729	
	4.22	Fork dimensions	s/e/l (mm)	60/173/1150	60/173/1220
	4.25	Distance between fork- arms	b5 (mm)	540/685	
	4.32	Ground clearance, centre of wheelbase	m2mm	25	23
	4.33	Aisle width for pallets 800X1200 lengthways	Ast (mm)	2300	2370
	4.35	Turning radius	Wa (mm)	1610	1680
Performance data	5.1	Travel speed, laden/ unladen	km/h	5.8/5.5	
	5.2	Lift speed, laden/ unladen	m/s	0.03/0.05	
	5.3	Lowering speed, laden/ unladen	m/s	0.05/0.04	
	5.8	Max. gradeability, laden/ unladen	%	4/10	
	5.10	Service brake		Electromagnetic	
Electric- engine	6.1	Drive motor rating S2 60min	kW	0.9	
	6.2	Lift motor rating at S3 15%	kW	0.8	
	6.3	Battery acc. to DIN 43531/ 35/ 36 A, B, C, no		No	
	6.4	Battery voltage, nominal capacity K5	V/Ah	3 12V/85Ah	
	6.5	Battery weight	kg	100	
	6.6	Energy consumption acc. to VDI cycle	KWh/h	0.28	
Addition data	8.1	Type of drive control		DC- speed control	
	8.4	Sound level at driver's ear acc. to EN 12053	dB(A)	69	

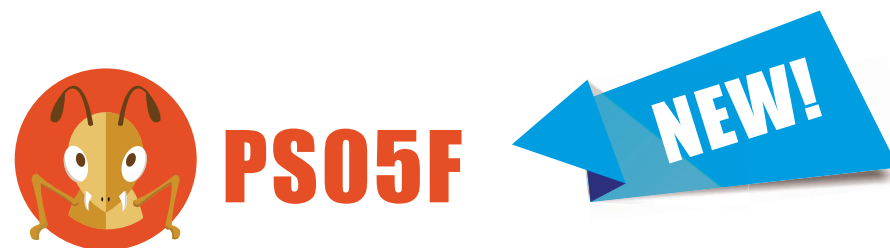

Self-lift Stacker Rated Load 500Kg

- Self-lift Stacker

INTRODUCTION

Self-lift Stacker(or “Flying” Stacker) is an innovation and unique choice for delivery of goods, one product can replace your Tail-lift, Hand Pallet Truck, Stacker, Ramp and Swing lift. It is easy and quick to transport, by loading itself into your Van, Pick-up, Lorry, or Trailer (with or without a load on the forks), so that there will be no unloading or reloading problems at your destination, which increases the efficiency significantly and makes the deliveries easier and faster.

▶ **Application Video**
Please find the application video for the PS05F at <http://www.noblelift.com>



PS05F

◀ Advantage

- Muti-purpose functions with its unique Self-Lift design, it is so convenient to travel with the vehicle to serve for different purposes.
- Unique design to ensure the stacker can lift itself safely without a load on its forks.
- The Noblelift 12V/42Ah maintenance-free battery for stable performance and easy service and maintenance.
- High performance pump unit gives fast and stable lift and low noise.

◀ Operation flow

Push the pallet into the lorry

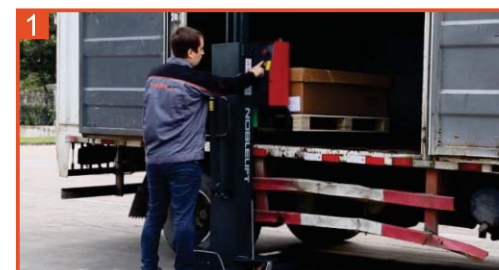

Check the position of truck



Lift the truck from the ground surface

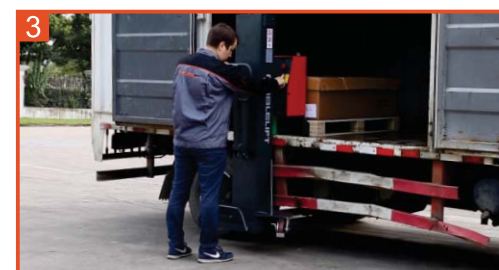

Remove the pin



Pull out supporting legs



Continue to lift the truck



Push back supporting legs



Install the pin



Lift the load and push the truck inside





Tiller with lifting /lowering button



Reliable protection for wires

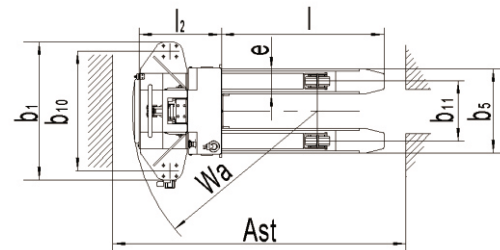
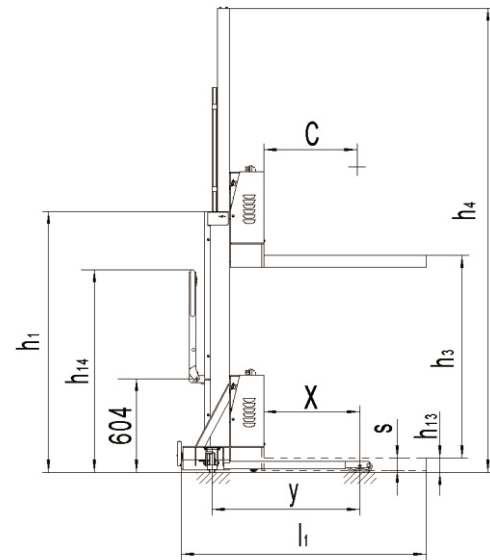

Easy maintenance

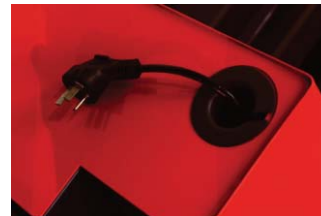

Built in charger

Built-in Charger for easy charging between deliveries on the vehicles.



Emergency switch



Castors with brakes

Wheel protection as well as foot brake to make sure the stacker travels with the vehicle safely.

Type sheet for industrial truck acc. to VDI 2198 1KG=2.2LB 1INCH=25.4MM

Distinguishing mark	1.2	Manufacturer's type designation		PS 05F-1300	PS 05F-800
	1.3	Power (battery ,diesel, petrol, gas, manual)		Manual	Manual
	1.4	Operator type		Pedestrian	Pedestrian
	1.5	Load Capacity / rated load	Q (t)	0.5	0.5
	1.6	Load centre distance	C (mm)	500	500
	1.8	Load distance ,centre of drive axle to fork	X (mm)	618	618
Weight	1.9	Wheelbase	Y (mm)	951	951
	2.1	Service weight	kg	303	277
	2.2	Axle loading, laden front/rear	kg	237/566	225/552
Tires, chassis	2.3	Axle loading, unladen front/ rear	kg	175/128	163/114
	3.1	Tires		Polyurethane (PU)	Polyurethane (PU)
	3.2	Tire size, front	ø x w	ø128 x 40	ø128 x 40
	3.3	Tire size, rear	ø x w	ø74 x 60	ø74 x 60
	3.5	Wheels, number front/rear(x=driven)		2/4	2/4
	3.6	Tread, front	b10 (mm)	768	768
Dimensions	3.7	Tread, rear	b11 (mm)	386	386
	4.2	Lowered mast height	h1 (mm)	1681	1181
	4.4	Lift	h3 (mm)	1300	800
	4.5	Extended mast height	h4 (mm)	3000	1990
	4.9	Height of tiller in drive position min./ max.	h14 (mm)	980/ 1300	980/ 1300
	4.15	Height, lowered	h13 (mm)	80	80
	4.19	Overall length	l1 (mm)	1608	1608
	4.20	Length to face of forks	l2 (mm)	523	523
	4.21	Overall width	b1 (mm)	888	888
	4.22	Fork dimensions	s/e/l (mm)	75/160/1050	75/160/1050
	4.25	Distance between fork- arms	b5 (mm)	540	540
	4.33	Aisle width for pallets 1000X1200	Ast (mm)	2481	2481
	4.34	Aisle width for pallets 800X1200	Ast (mm)	2181	2181
	4.35	Turning radius	Wa (mm)	1200	1200
Performance data	5.2	Lift speed, laden/ unladen	m/s	0.047/0.060	0.047/0.060
	5.3	Lowering speed, laden/ unladen	m/s	0.144/0.103	0.144/0.103
Electric- engine	6.2	Lift motor rating at S3 7.5%	kW	0.8	0.8
	6.3	Battery acc. to DIN43 531/35/36 A,B,C,no		Maintenance free	Maintenance free
	6.4	Battery voltage, nominal capacity K51)	V/Ah	12/42	12/42
	6.5	Battery weight	kg	14	14



ECL 10/ECL 10M

Economic Power- Electric Stacker Compact and Reliable Design

INTRODUCTION

The ECL10M is an economic walkie-electric stacker, with rated capacity of 1000kg/2200lbs and lifting height from 1600mm/63inch to 3500mm/138inch.

The compact and light design is suitable for a variety low duty applications in warehouses .

ADVANTAGES

- Ideal solution for low-duty applications.
- Built- in charger for high autonomy.
- Battery discharge indicator with automatic lift cut-off function for higher battery lifetime.
- 4-wheel design with sideways tiller for high stability and perfect view.



Built-in charger
The built-in charger makes operations more autonomy and increases the operating range.

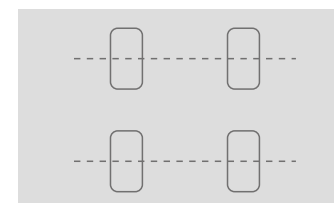

Stability
4-Wheel design with sideways tiller for excellent view and maneuverability as well as high stability.



Robust profile
Robust mast with real mast profiles for perfect stability, accuracy and high lifetime.



Powerful battery
2x12V 85Ah powerful VRLA-AGM main-tenance free batteries (option 2x12V 106Ah).



Battery deep discharge protection
Proofed and ergonomic emergency button and discharge indicator, more robust and reliable than other. The included automatic battery protection ensures high lifetime for the batteries.

Proofed components
Proofed components such as sensors, micro-switches, controller and hydraulic power- pack from international brands.

Fulfilling standards
Fulfilling the actual valid European standards, also in ISO 13849, performance level.

Applications
Ideal economic solution for all indoor low duty and occasional stacking operations.



Optional straddle leg
Adjustable straddle leg design, suitable for diverse pallet sizes and more stability.

Economic robust handle
Robust but economic handle with steel housing and plastic coating ensures reliable and comfortable operation.

Several masts
2 single mast versions(1600mm/63inch, 2000mm/78.7inch lift height) and one 2-stage duplex mast with 2900mm/114inch, 3200mm/126inch and 3500mm/138inch (All with perfect view through the mast). b5=686mm/27inch and straddle leg version optional. (b5=569mm/22.4inch standard).

Other type date										
1.2	Manufacturer's type designation		ECL1016	ECL1020	ECL1032	ECL1035	ECL1016 M	ECL1020 M	ECL1032M	ECL1035M
1.8	Load distance ,centre of drive axle to fork	x(mm)	812		800		745		733	
2.1	Service weight	kg	430	450	525	540	676	696	771	786
2.2	Axle loading, laden front/rear	kg	550/880	560/890	590/935	600/940	736/940	756/940	796/975	406/980
2.3	Axle loading, unladen front/rear	kg	335/105	340/110	395/130	405/135	500/176	510/186	540/231	550/236
4.2	Lowered mast height	h1 (mm)	1950	2350	2100	2250	1940	2335	2085	2235
4.3	Free Lift height	h2 (mm)	1530	1930	70	70	1530	1930	70	70
4.4	Lift	h3 (mm)	1530	1930	3140	3440	1530	1930	3140	3440
4.5	Extended mast height	h4 (mm)	1950	2350	3625	3925	2120	2520	3720	4020
4.20	Length to face of forks	l2 (mm)	620		632		688		700	
4.33	Aisle width for pallets 1000X1200 crossways	Ast (mm)	2314		2318		2336		2341	
4.34	Aisle width for pallets 800X1200 lengthways	Ast (mm)	2242		2250		2290		2300	
6.6	Energy consumption acc. to VDI cycle	kWh/h	0.68		0.73		0.71		0.76	

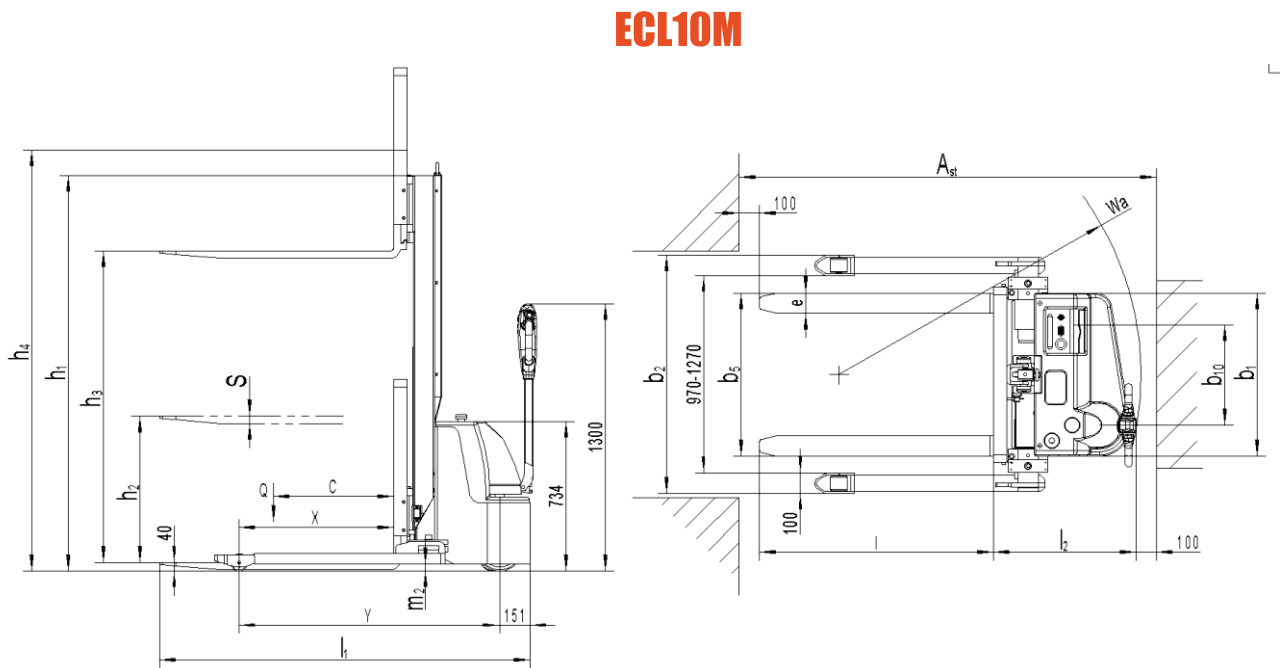

Type sheet for industrial truck acc. to VDI 2198 1KG=2.2LB 1INCH=25.4MM					
Distinguishing mark	1.2	Manufacturer's type designation	ECL1029		ECL1029M
	1.3	Drive	Battery		
	1.4	Operator type	Pedestrian		
	1.5	Load Capacity / rated load	Q (t)	1.0	
	1.6	Load centre distance	C (mm)	600	
	1.8	Load distance ,centre of drive axle to fork	X (mm)	800	733
Weight	1.9	Wheelbase	Y (mm)	1281	
	2.1	Service weight	kg	510	756
	2.2	Axle loading, laden front/rear	kg	580/930	786/970
	2.3	Axle loading, unladen front/rear	kg	385/125	530/226
Tyres, chassis	3.1	Tires	Polyurethane (PU)		
	3.2	Tire size, front	Ø x w (mm)	Ø220 × 70	
	3.3	Tire size, rear	Ø x w (mm)	Ø84 × 70	
	3.4	Additional wheels(dimensions)	Ø x w (mm)	Ø124 × 60	
	3.5	Wheels, number front/rear(x=driven wheels)		1x+1 / 2	
	3.6	Tread, front	b10 (mm)	529	
	3.7	Tread, rear	b11 (mm)	—	
Dimensions	4.2	Lowered mast height	h1 (mm)	1950	1940
	4.3	Free Lift height	h2 (mm)	70	70
	4.4	Lift	h3 (mm)	2840	2740
	4.5	Extended mast height	h4 (mm)	3325	3420
	4.9	Height of tiller in drive position min./ max.	h14 (mm)	785/1300	
	4.15	Height, lowered	h13 (mm)	85	40
	4.19	Overall length	l1 (mm)	1800	1838
	4.20	Length to face of forks	l2 (mm)	632	700
	4.21	Overall width	b1/b2(mm)	800	800(1170-1470)
	4.22	Fork dimensions	s/e/l (mm)	60/150/1150	35/100/1150 ¹⁾
	4.25	Distance between fork- arms	b5 (mm)	570/685	282-800
	4.32	Ground clearance, centre of wheelbase	m2 (mm)	29	35
	4.33	Aisle width for pallets 1000X1200 crossways	Ast (mm)	2318	2341
	4.34	Aisle width for pallets 800X1200 lengthways	Ast (mm)	2250	2300
	4.35	Turning radius	Wa (mm)	1485	
Performance data	5.1	Travel speed, laden/ unladen	km/h	4.3/4.5	
	5.2	Lift speed, laden/ unladen	m/s	0.11/0.16	
	5.3	Lowering speed, laden/ unladen	m/s	0.13/0.11	
	5.8	Max. gradeability, laden/ unladen	%	5/10	
	5.10	Service brake		Electromagnetic	
Electric- Motor	6.1	Drive motor rating S2 60min	kW	0.45	
	6.2	Lift motor rating at S3 7.5%	kW	2.2	
	6.3	Battery acc. to DIN 43531/ 35/ 36 A, B, C, no		no	
	6.4	Battery voltage, nominal capacity K5	V/Ah	2X 12/ 85 ²⁾	
	6.5	Battery weight	kg	2X 25	
	6.6	Energy consumption acc. to VDI cycle	kWh/h	0.73	0.76
Additional data	8.1	Type of drive control		DC- Speed Control	
	8.4	Sound level at driver's ear acc. to EN 12053	dB(A)	< 70	

For specifications of the other lifting heights, please refer to the other type data. 1) Optional:35/100/950 2) Optional:2x12V/106/Ah



ECL 10SC

Electric Stacker with scale

Totalising function

Adds up multiple pallet weights to a total weight per shipment or order, also for avoiding overloads. When weight is added, the display shows the new total weight and the number of pallets weighed. This permits the user to verify that he did not forget to weigh any pallets or weighed the same pallet twice.



Standard ESR-ST-4 kit for ECL10SC:

- Tolerance: +/-0.4% of the rated truck capacity 1000kg(max +/-4kg) by standard loadcells.
- Graduation in 1 and 2kg steps(multirange).
- Scale functions: zero correction, gross/net weighing, total weight.
- Power supply: 4x1.5V AA batteries.
- Low battery warning + auto shut off function after 3 minutes.

High battery autonomy

Four standard AA-batteries (2.7Ah) allow 70 hours of use. The automatic sleep mode assures that 4200 weighting actions can be taken. In most common use this means that batteries will have to be changed* only one time per year (*or charged if rechargeable batteries are used).

High contrast display

Display can be read from any angle: when operator is standing near the pallet for dosing, or for adding products to the pallet by weight. The display does not need a backlight because it reads extremely well at ambient light conditions.

Big function keys that "click"

When pushing the function keys, the operator senses a "click" movement. Even when working with gloves, the operator feels whether he has pressed the key properly.

OPTIONAL

Option 1: Improved Accuracy

- Tolerance: +/-0.2% of the rated truck capacity by better loadcells.
- Graduation in 1kg steps for the full range.

Option 2: Power supply by truck battery

- Internal power converter with input range 12-40V.

Technical data sheet for industrial trucks acc. to VDI 2198 1KG=2.2LB 1INCH=25.4MM

Distinguishing mark	1.2	Manufacturer's type designation		ECL10SC
	1.3	Drive		Electric
	1.4	Operator type		Pedestrian
	1.5	Load Capacity / rated load	Q(t)	1.0
	1.6	Load centre distance	c(mm)	600
	1.8	Load distance ,centre of drive axle to fork	x(mm)	780
	1.9	Wheelbase	Y(mm)	1281
Weight	2.1	Service weight	kg	570
	2.2	Axle loading, laden front/rear	kg	590/960
	2.3	Axle loading, unladen front/rear	kg	405/145
Tires, chassis	3.1	Tires		Polyurethane (PU)
	3.2	Tire size, front	Øx w (mm)	Ø220 x 70
	3.3	Tire size, rear	Øx w (mm)	Ø80x93
	3.4	Additional wheels(dimensions)	Øx w (mm)	Ø124x60
	3.5	Wheels, number front/rear(x=driven wheels)		1x+1/2
	3.6	Track, front	b10mm	529
	3.7	Track, rear	b11 (mm)	420/535
Dimensions	4.2	Lowered mast height	h1 (mm)	1950
	4.3	Free Lift height	h2 (mm)	70
	4.4	Lift	h3 (mm)	2808
	4.5	Extended mast height	h4 (mm)	3325
	4.9	Height of tiller in drive position min./ max.	h14mm	785/1300
	4.15	Height, lowered	h13mm	92
	4.19	Overall length	l1mm	1820
	4.20	Length to face of forks	l2mm	652
	4.21	Overall width	b1mm	800
	4.22	Fork dimensions	s/e/l (mm)	83/167/1150
	4.25	Distance between fork-arms	b5 (mm)	584
	4.32	Ground clearance, centre of wheelbase	m2mm	9
	4.33	Aisle width for pallets 1000X1200 crossways	Ast (mm)	2318
	4.34	Aisle width for pallets 800X1200 lengthways	Ast (mm)	2250
	4.35	Turning radius	Wa (mm)	1485
Performance data	5.1	Travel speed, laden/ unladen	km/h	4.3/4.5
	5.2	Lift speed, laden/ unladen	m/s	0.11/0.16
	5.3	Lowering speed, laden/ unladen	m/s	0.13/0.11
	5.8	Max. gradeability, laden/ unladen	%	5/10
	5.10	Service brake		electromagnetic
Electric- engine	6.1	Drive motor rating S2 60min	kW	0.45
	6.2	Lift motor rating at S3 7.5%	kW	2.2
	6.3	Battery acc. to DIN 43531/35/36 A, B, C, no		no
	6.4	Battery voltage, nominal capacity K5	V/Ah	2X 12/ 85 ¹⁾
	6.5	Battery weighi	kg	2X25
	6.6	Energy consumption acc: to VDI cycle	kWh/h	0.73
Additional data	8.1	Type of drive control		DC- Speed Controller
	8.4	Sound level at driver's ear acc. to EN 12053	dB(A)	< 70

Water and dust proof to norm IP65

One of the most important characteristics for a reliable mobile scale. IP65 means that the pallet truck scale can be used outside or lorries and be cleaned with water (but not by high pressure !!!) The load cells in the forks have an even higher protection level.

Product is CE conform for Europe and FUC conform for the USA

